

OU5047

OUE-HPKG/US-100-DPO

Photoelectric sensors

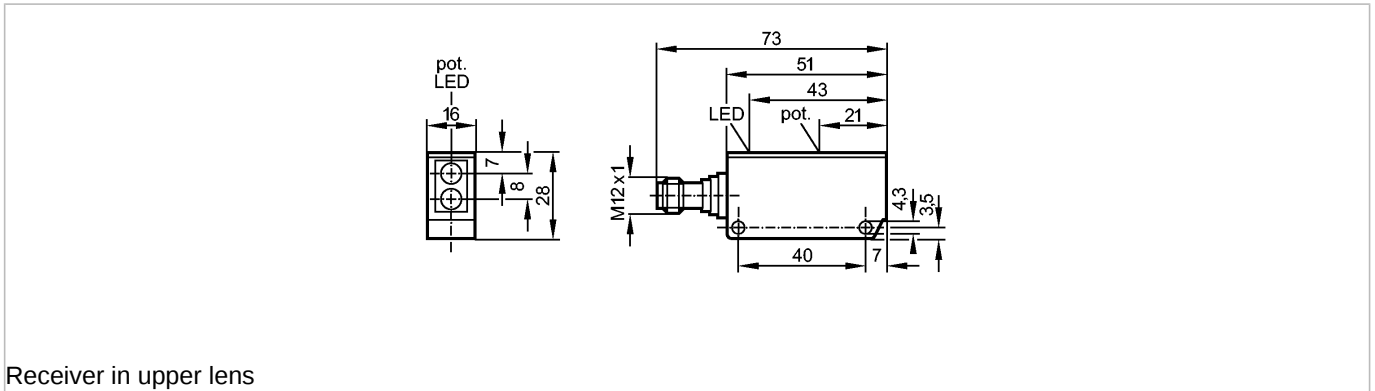

Receiver in upper lens



Product characteristics

Through-beam sensor
Rectangular, plastics
Quick disconnect
Receiver
Sensing range 6m adjustable

Electrical data

Electrical design	DC PNP
Operating voltage [V]	10...55 DC
Current consumption [mA]	20 (24 V)
Type of light	Infrared light 880 nm
Protection class	III
Reverse polarity protection	yes

Outputs

Output function	light-on mode
Voltage drop [V]	< 2.5
Current rating [mA]	250
Short-circuit protection	yes (non-latching)
Overload protection	yes
Switching frequency [Hz]	140

Monitoring range

Sensing range [m]	6
-------------------	---

Excess gain graphs

OU5047

OUE-HPKG/US-100-DPO

Photoelectric sensors

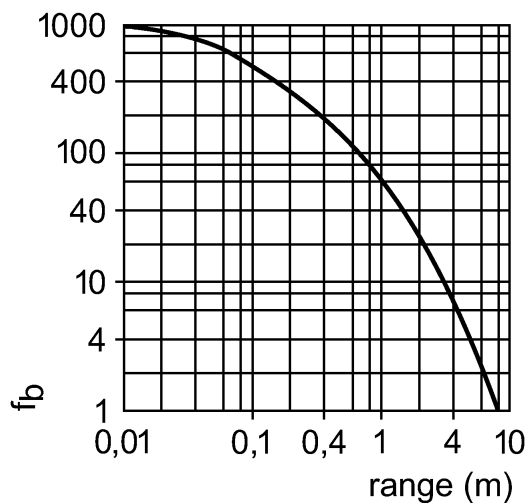

Environment

Ambient temperature	[°C]	-25...80
Protection		IP 67

Tests / approvals

EMC		EN 60947-5-2
MTTF	[Years]	618

Mechanical data

Housing materials		modified PPO
Lens material		glass
Weight	[kg]	0.073

Displays / operating elements

Output status indication	LED	yellow
--------------------------	-----	--------

Electrical connection

Connection		M12 connector
------------	--	---------------

Wiring

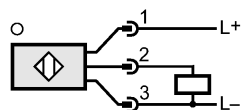

Accessories

Accessories (included)		Angle bracket; E20211
------------------------	--	-----------------------

Remarks

Pack quantity	[piece]	1
---------------	---------	---