

OU5043

OUF-HPKG/US-100-DPS

Photoelectric sensors

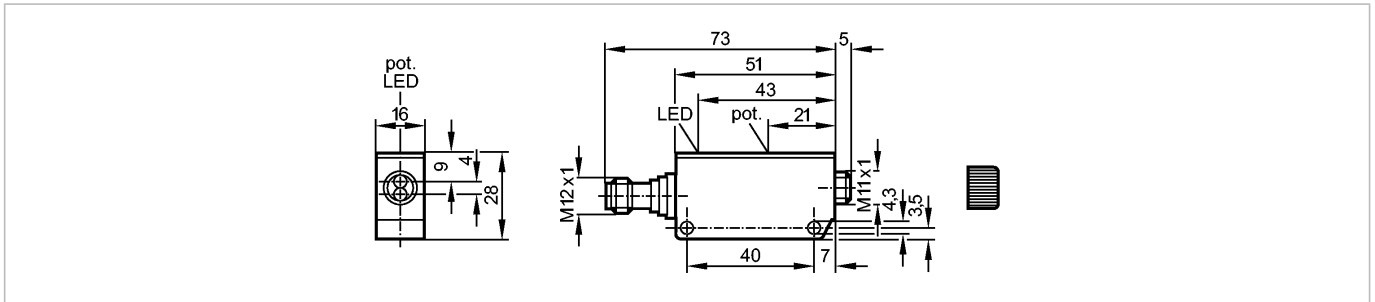

Product characteristics

Fiber-optic amplifier
Rectangular, plastics
Quick disconnect
Sensing range 0...120mm (Through-beam sensor)
Range 0...40mm (Diffuse reflection sensor)
adjustable

Electrical data

Electrical design	DC PNP
Operating voltage [V]	10...36 DC
Current consumption [mA]	35 (24 V)
Type of light	Infrared light 880 nm
Protection class	III
Reverse polarity protection	yes

Outputs

Output function	light-on mode
Voltage drop [V]	< 2.5
Current rating [mA]	250
Short-circuit protection	yes (non-latching)
Overload protection	yes
Switching frequency [Hz]	100

Monitoring range

Sensing range [m]	0...0.12 (Through-beam sensor)
Range [mm]	0...40 (Diffuse reflection sensor)

Excess gain graphs

OU5043

OUF-HPKG/US-100-DPS

Photoelectric sensors

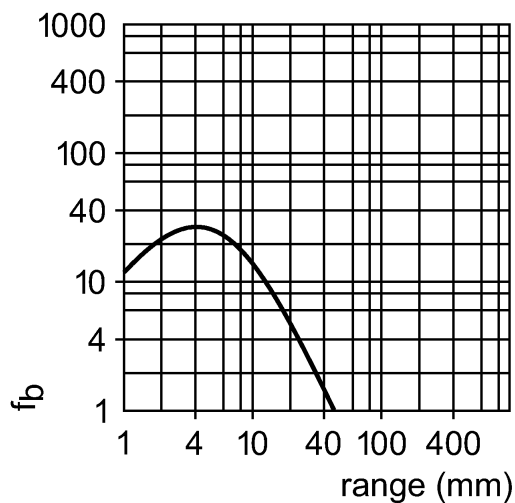

Environment

Ambient temperature	[°C]	-25...80
Protection		IP 65

Tests / approvals

EMC		EN 60947-5-2 EN 55011:	class B
MTTF	[Years]		653

Mechanical data

Housing materials		modified PPO
Lens material		glass
Weight	[kg]	0.075

Displays / operating elements

Output status indication	LED	yellow
--------------------------	-----	--------

Electrical connection

Connection		M12 connector
------------	--	---------------

Wiring

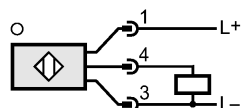

Accessories

Accessories (included)		Angle bracket; E20211; screwdriver
------------------------	--	------------------------------------

Remarks

Remarks		When through-beam fibre optics are connected light-on mode means the output function "NC" and when diffuse reflection fibre optics are connected the output function "NO".
---------	--	--

Pack quantity	[piece]	1
---------------	---------	---