

OPU702

OPULFPKG/AS

Photoelectric sensors

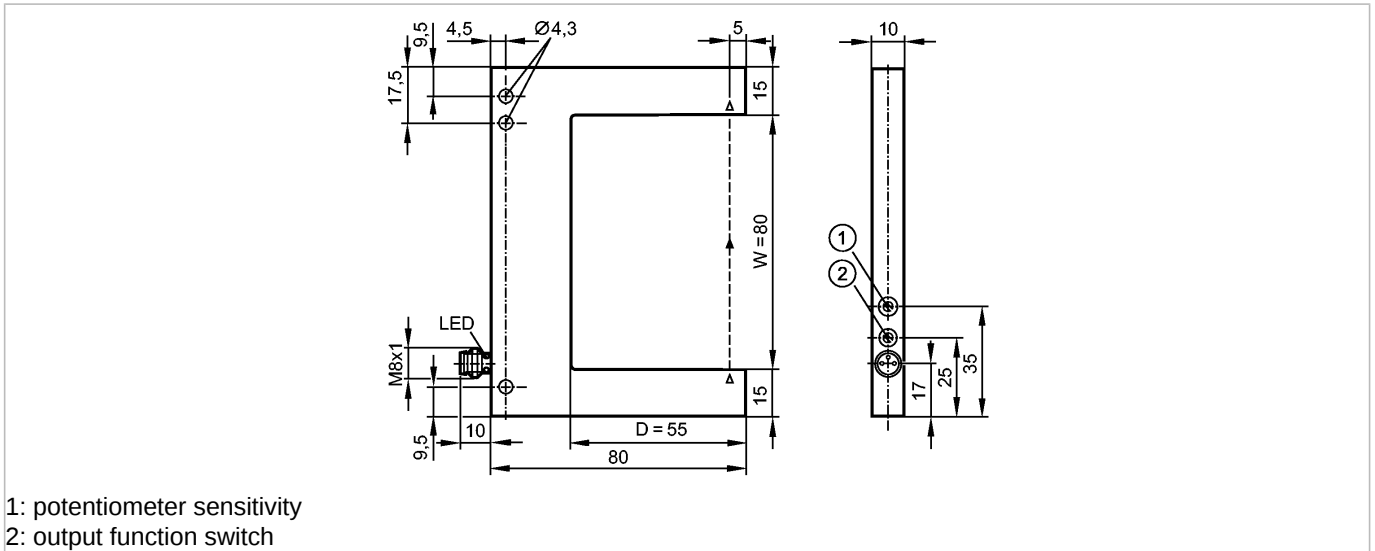

Product characteristics

Optical fork sensor
Quick disconnect
Visible laser light, LASER CLASS 1

Electrical data

Electrical design	DC PNP
Operating voltage [V]	10...30 DC
Current consumption [mA]	30
Type of light	red light 670 nm
Protection class	III
Reverse polarity protection	yes

Outputs

Output function	light-on/dark-on mode selectable
Voltage drop [V]	< 2.8
Current rating [mA]	200
Short-circuit protection	yes (non-latching)
Overload protection	yes
Switching frequency [Hz]	3000

Monitoring range

Smallest detectable object [mm]	0.05
Hysteresis [mm]	0.02

Accuracy / deviations

Repeatability [mm]	0.01
--------------------	------

Environment

Ambient temperature [°C]	5...45
Protection	IP 67

Tests / approvals

EMC	EN 60947-5-2
MTTF [Years]	475

Mechanical data

Fork depth D [mm]	55
-------------------	----

OPU702

OPULFPKG/AS

Photoelectric sensors

Fork width W	[mm]	80
Housing materials		housing: aluminum black anodized; lens: glass
Weight	[kg]	0.138

Displays / operating elements

Output status indication	LED	yellow
--------------------------	-----	--------

Electrical connection

Connection	M8 connector
------------	--------------

Wiring

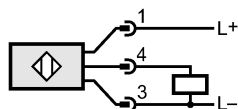

Remarks

Remarks	<p>Laser light CLASS 1 LASER PRODUCT IEC 60825-1 : 2007 complies with 21 CFR 1040.10 except for deviations pursuant to Laser Notice No. 50, dated June 2007 cULus - Class 2 source required</p>
---------	--

Pack quantity	[piece]	1
---------------	---------	---