

NI5004

IIA2015-N/1D/1G/2G

Inductive sensors

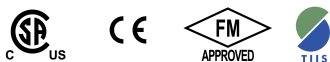
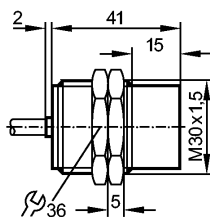

| Product characteristics | |
|---|--|
| Inductive sensor | |
| Metal thread M30 x 1.5 | |
| Cable | |
| ATEX approval | |
| Group II, category 1D | |
| Group II, category 1G/2G | |
| Sensing range 15 mm; [nf] non-flush mountable | |
| Electrical data | |
| Electrical design | Connection to certified intrinsically safe circuits with the max. values $U = 15 \text{ V} / I = 50 \text{ mA} / P = 120 \text{ mW}$ |
| Nominal voltage [V] | 8.2 DC; (1k Ω) |
| Supply voltage [V] | 7.5...30 DC; when used outside the hazardous area |
| Current consumption [mA] | < 1 disabled; (> 2.1 mA enabled) |
| Protection class | III |
| Outputs | |
| Output function | normally closed |
| Current rating [mA] | < 30; when used outside the hazardous area |
| Switching frequency [Hz] | 200 |
| Monitoring range | |
| Sensing range [mm] | 15 |
| Real sensing range (Sr) [mm] | 15 \pm 10 % |
| Accuracy / deviations | |
| Correction factors | mild steel = 1 / stainless steel approx. 0.7 / brass approx. 0.5 / aluminium approx. 0.4 / copper approx. 0.3 |
| Hysteresis [% of Sr] | 1...15 |
| Switch-point drift [% of Sr] | -10...10 |
| Environment | |
| Ambient temperature [°C] | -20...80 |
| Protection | IP 67 |
| Tests / approvals | |
| Approval | PTB 01 ATEX 2191 BVS 04 ATEX E153 TIIS TC16109 |
| Marking of the unit | Ⓔ II 1G Ex ia IIB T6 Ga Ⓔ II 2G Ex ia IIC T6 Gb Ⓔ II 1D Ex ia IIIC T 90°C Da |
| EMC | EN 60947-5-6 |
| Shock / vibration resistance | 30 g (11 ms) / 10-55 Hz (1 mm) |



NI5004

IIA2015-N/1D/1G/2G

Inductive sensors

| | | |
|------|---------|------|
| MTTF | [Years] | 4963 |
|------|---------|------|

Safety classification

| | | |
|----------------------|------|-------|
| Internal capacitance | [nF] | < 145 |
| Internal inductance | [μH] | < 110 |

Mechanical data

| | | |
|-------------------|---|-------|
| Mounting | non-flush mountable | |
| Housing materials | brass special coating; active face: PBT | |
| Weight | [kg] | 0.221 |

Electrical connection

| | | |
|------------|--|--|
| Connection | PVC cable / 2 m; 2 x 0.5 mm ² | |
|------------|--|--|

Wiring

Core colors
 BN brown
 BU blue

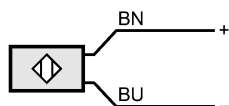

Accessories

| | | |
|------------------------|-------------|--|
| Accessories (included) | 2 lock nuts | |
|------------------------|-------------|--|

Remarks

| | | |
|---------------|---------|---|
| Pack quantity | [piece] | 1 |
|---------------|---------|---|