

NG5004

IGA2008-N/1D/1G/2G

Inductive sensors

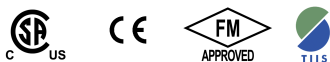
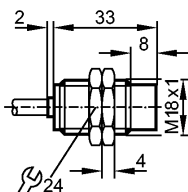

Product characteristics

Inductive sensor
Metal thread M18 x 1
Cable
ATEX approval
Group II, category 1D
Group II, category 1G/2G
Sensing range 8 mm; [nf] non-flush mountable

Electrical data

Electrical design	Connection to certified intrinsically safe circuits with the max. values U = 15 V / I = 50 mA / P = 120 mW
Nominal voltage [V]	8.2 DC; (1kΩ)
Supply voltage [V]	7.5...30 DC; when used outside the hazardous area
Current consumption [mA]	< 1 disabled; (> 2.1 mA enabled)
Protection class	II

Outputs

Output function	normally closed
Current rating [mA]	< 30; when used outside the hazardous area
Switching frequency [Hz]	300

Monitoring range

Sensing range [mm]	8
Real sensing range (Sr) [mm]	8 ± 10 %

Accuracy / deviations

Correction factors	mild steel = 1 / stainless steel approx. 0.7 / brass approx. 0.5 / aluminium approx. 0.4 / copper approx. 0.3
Hysteresis [% of Sr]	1...15
Switch-point drift [% of Sr]	-10...10

Environment

Ambient temperature [°C]	-20...80
Protection	IP 67

Tests / approvals

Approval	PTB 01 ATEX 2191 BVS 04 ATEX E153 TIIS TC16108
Marking of the unit	⊕ II 1G Ex ia IIB T6 Ga ⊕ II 2G Ex ia IIC T6 Gb ⊕ II 1D Ex ia IIIC T 90°C Da
EMC	EN 60947-5-6
Shock / vibration resistance	30 g (11 ms) / 10-55 Hz (1 mm)



NG5004

IGA2008-N/1D/1G/2G

Inductive sensors

MTTF	[Years]	4756
------	---------	------

Safety classification

Internal capacitance	[nF]	< 155
Internal inductance	[μH]	< 50

Mechanical data

Mounting	non-flush mountable	
Housing materials	brass white bronze coated; active face: PBT	
Weight	[kg]	0.172

Electrical connection

Connection	PVC cable / 2 m; 2 x 0.5 mm ²	
------------	--	--

Wiring

Core colors

BN brown

BU blue

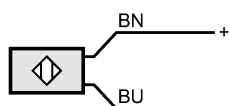

Accessories

Accessories (included)	2 lock nuts	
------------------------	-------------	--

Remarks

Pack quantity	[piece]	1
---------------	---------	---