

**MFH200**

MFA3002BBPKG/B/AM/500/US

Magnetic sensors, cylinder sensors

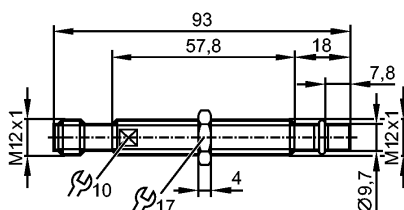

**Product characteristics**

Cylinder sensor
Metal thread M12 x 1
Quick disconnect
Pressure rating
Detects ferrous metals
Full metal housing
Sensing range 1.8 mm; [f] flush mountable

**Application**

Application	Hydraulic cylinder
-------------	--------------------

**Electrical data**

Electrical design	DC PNP
Operating voltage [V]	10...36 DC
Current consumption [mA]	< 23
Protection class	III
Reverse polarity protection	yes

**Outputs**

Output function	normally open
Voltage drop [V]	< 1.6
Leakage current [mA]	< 0.1
Current rating [mA]	200
Short-circuit protection	yes (non-latching)
Overload protection	yes
Switching frequency [Hz]	1000

**Monitoring range**

Sensing range [mm]	1.8
--------------------	-----

**Accuracy / deviations**

Hysteresis [% of Sr]	≤ 10
Switch-point drift [% of Sr]	10
Repeatability [% of Sr]	10

**Environment**

Pressure rating [bar]	500
Bursting pressure min. [bar]	2000
Pressure peak [bar]	1000
Min. pressure cycles	1 x 10E7
Ambient temperature [°C]	-25...120
Protection	IP 65 / IP 68 / IP 69K

**Tests / approvals**

**MFH200**

MFA3002BBPKG/B/AM/500/US

Magnetic sensors, cylinder sensors

EMC	EN 61000-4-2 ESD: EN 61000-4-3 HF radiated: EN 61000-4-4 Burst: EN 61000-4-6 HF conducted: EN 55011: DIN ISO 11452-5:	4 kV CD / 8 kV AD 10 V/m 2 kV 10 V class B 100 V/m
Vibration resistance	EN 60068-2-6 Fc	20 g 50 cycles per frequency, 1 octave per minute in each of 3 mutually perpendicular axes / 10...3000 Hz -20°C and 50°C
Shock resistance	EN 60068-2-27 Ea  EN 60068-2-27 Ea	100 g (11 ms half sine; 3 shocks in each direction along the three coordinate axes) / -40°C and 85°C 40 g (6 ms; 4000 shocks in each direction along the three coordinate axes) / -20°C and 50°C
MTTF [Years]		658
UL approval number		C005

**Mechanical data**

Mounting	flush mountable	
Housing materials	housing: stainless steel; connector: PEI; O-ring: FPM; Supporting ring: PTFE	
Installation		

Tightening torque [Nm]	< 15
Weight [kg]	0.045

**Displays / operating elements**

Output status indication	LED	-
--------------------------	-----	---

**Electrical connection**

Connection	M12 connector
------------	---------------

**Wiring**

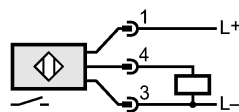

**Accessories**

Accessories (included)	1 lock nut
------------------------	------------

**Remarks**



**MFH200**

MFA3002BBPKG/B/AM/500/US

**Magnetic sensors, cylinder sensors**

Pack quantity [piece] 1