

**KI5304**

KI-3150QAPKG/SL/1P/IO

Capacitive sensors

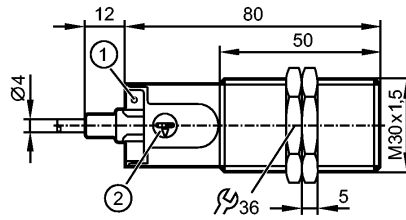

- 1: LED yellow (output status indication)
- 2: Potentiometer (sensing range)

CE EAC IO-Link

**Product characteristics**

Capacitive sensor
Plastic thread M30 x 1.5
Cable
Sensing range 15 mm; adjustable 0.5...40 mm; [quasi-flush mountS] quasi-flush mount

**Electrical data**

Electrical design	DC PNP
Operating voltage [V]	10...30 DC
Current consumption [mA]	< 22
Protection class	III
Reverse polarity protection	yes

**Outputs**

Output function	normally closed
Voltage drop [V]	< 2.5
Current rating [mA]	200
Short-circuit protection	yes
Overload protection	yes
Switching frequency [Hz]	40

**Monitoring range**

Sensing range [mm]	15, adjustable 0.5...40 mm
Real sensing range (Sr) [mm]	15 ± 10 %

**Accuracy / deviations**

Hysteresis [% of Sr]	1...15
Switch-point drift [% of Sr]	-15...15

**Interfaces**

IO-Link Device	
Transfer type	COM2 (38.4 kBaud)
IO-Link revision	1.1
SDCI standard	IEC 61131-9
Profiles	Smart Sensor: Process Data Variable; Device Identification
SIO mode	yes
Required master port class	A
Min. process cycle time [ms]	20

**Environment**

Ambient temperature [°C]	-25...80
Medium temperature [°C]	-25...110

**KI5304**

KI-3150QAPKG/SL/1P/IO

**Capacitive sensors**

Protection	IP 65 / IP 67 / IP 69K
------------	------------------------

**Tests / approvals**

EMC	EN 61000-4-2 EN 61000-4-3 EN 61000-4-4 EN 61000-4-6 EN 55011:	30 kV AD / 4 kV CD 10 V/m 2 kV 10 V class B
Vibration resistance	DIN EN 60947-5-2	1 mm amplitude, vibration duration 5 min., 30 min. per axis with resonance or 55 Hz
Shock resistance	DIN EN 60947-5-2	30 g 6 shocks / 11 ms half-sine (x,y,z)
MTTF [Years]		903.84

**Mechanical data**

Mounting	quasi-flush mount
Housing materials	PBT; PC; POM
Weight [kg]	0.101

**Displays / operating elements**

Output status indication	LED	yellow
--------------------------	-----	--------

**Electrical connection**

Connection	PUR cable / 2 m; 3 x 0.34 mm <sup>2</sup> ; Ø 4 mm
------------	--

**Wiring**

- Core colors
- BN brown
- BU blue
- BK black

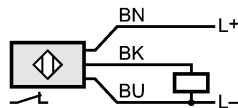

BK: OUT / IO-Link

**Accessories**

Accessories (included)	2 lock nuts
------------------------	-------------

**Remarks**

Pack quantity [piece]	1
-----------------------	---