

IZ5048

IZ93001-BPKG/2M PVC

Inductive sensors

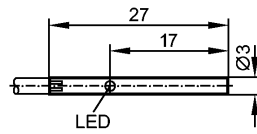

Product characteristics

| |
|--|
| Inductive sensor |
| Metal housing Ø 3 mm |
| Cable |
| Sensing range 1 mm; [nf] non-flush mountable |

Electrical data

| | |
|-----------------------------|------------|
| Electrical design | DC PNP |
| Operating voltage [V] | 10...30 DC |
| Current consumption [mA] | 12 (24 V) |
| Reverse polarity protection | yes |

Outputs

| | |
|--------------------------|--------------------|
| Output function | normally open |
| Voltage drop [V] | < 1.5 |
| Current rating [mA] | 100 |
| Short-circuit protection | yes (non-latching) |
| Overload protection | no |
| Switching frequency [Hz] | 5000 |

Monitoring range

| | |
|------------------------------|----------|
| Sensing range [mm] | 1 |
| Real sensing range (Sr) [mm] | 1 ± 10 % |
| Operating distance [mm] | 0...0.8 |

Accuracy / deviations

| | |
|------------------------------|---|
| Correction factors | mild steel = 1 / stainless steel approx. 0.7 / brass approx. 0.5 / aluminium approx. 0.4 / copper approx. 0.3 |
| Hysteresis [% of Sr] | < 15 |
| Switch-point drift [% of Sr] | -10...10 |

Environment

| | |
|--------------------------|--------|
| Ambient temperature [°C] | 0...70 |
| Protection | IP 67 |

Tests / approvals

| | |
|--------------|-----------------------------------|
| EMC | EN 60947-5-2 EN 55011: class B |
| MTTF [Years] | 735 |

Mechanical data

| | |
|-------------------|---|
| Mounting | non-flush mountable |
| Housing materials | housing: stainless steel; active face: POM (polyoxymethylene) |

IZ5048

IZ93001-BPKG/2M PVC

Inductive sensors

Installation

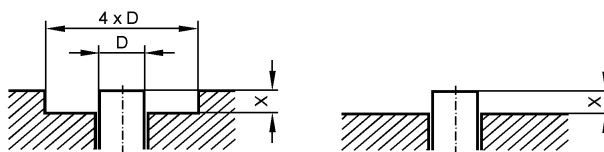

If S_r varies by $< 10\%$
 the following free space must be maintained:
 $X > 1.5\text{ mm}$ for ferromagnetic materials
 $X > 3.0\text{ mm}$ for other metals

| | | |
|--------|------|-------|
| Weight | [kg] | 0.048 |
|--------|------|-------|

Displays / operating elements

| | | |
|--------------------------|-----|-----|
| Output status indication | LED | red |
|--------------------------|-----|-----|

Electrical connection

| | |
|------------|---|
| Connection | PVC cable / 2 m; 3 x 0.14 mm ² |
|------------|---|

Wiring

Core colors

- BK black
- BN brown
- BU blue

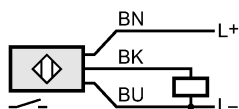

Accessories

| | |
|------------------------|------------------------|
| Accessories (included) | Mounting clamp; E20107 |
|------------------------|------------------------|

Remarks

| | | |
|---------------|---------|---|
| Pack quantity | [piece] | 1 |
|---------------|---------|---|