

**IIT213**

IIK3022-BPKG/M/V4A/US104-DPS

**Inductive sensors**

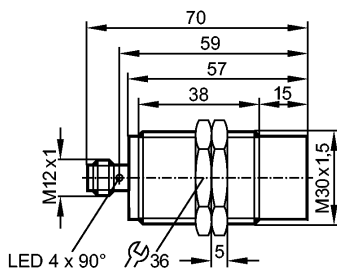

**Product characteristics**

Inductive sensor
Metal thread M30 x 1.5
Quick disconnect
Increased sensing range
gold-plated contacts
Sensing range 22 mm; [nf] non-flush mountable

**Electrical data**

Electrical design	DC PNP
Operating voltage [V]	10...36 DC
Current consumption [mA]	< 10
Protection class	II
Reverse polarity protection	yes

**Outputs**

Output function	normally open
Voltage drop [V]	< 2.5
Current rating [mA]	100
Short-circuit protection	yes (non-latching)
Overload protection	yes
Switching frequency [Hz]	100

**Monitoring range**

Sensing range [mm]	22
Real sensing range (Sr) [mm]	22 ± 10 %
Operating distance [mm]	0...17.6

**Accuracy / deviations**

Correction factors	mild steel = 1 / stainless steel approx. 0.7 / brass approx. 0.5 / aluminium approx. 0.5 / Cu approx. 0.4
Hysteresis [% of Sr]	1...20
Switch-point drift [% of Sr]	-10...10

**Environment**

Ambient temperature [°C]	0...100
Protection	IP 68 / IP 69K

**Tests / approvals**

EMC	EN 61000-4-2 ESD: 4 kV CD / 8 kV AD
	EN 61000-4-3 HF radiated: 10 V/m
	EN 61000-4-4 Burst: 2 kV
	EN 61000-4-5 Surge: 0.5 kV
	EN 61000-4-6 HF conducted: 10 V

**IIT213**

IHK3022-BPKG/M/V4A/US104-DPS

**Inductive sensors**

	EN 55011:	class B
MTTF	[Years]	1594

**Mechanical data**

Mounting	non-flush mountable
Housing materials	threaded sleeve: stainless steel (316L); active face: PEEK (polyether ether ketone); lock nuts: high-grade stainless steel
Weight	[kg] 0.125

**Displays / operating elements**

Output status indication	LED	yellow (4 x 90°)
--------------------------	-----	------------------

**Electrical connection**

Connection	M12 connector; gold-plated contacts
------------	-------------------------------------

**Wiring**

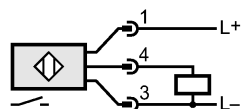

**Accessories**

Accessories (included)	2 lock nuts
------------------------	-------------

**Remarks**

Pack quantity	[piece]	1
---------------	---------	---