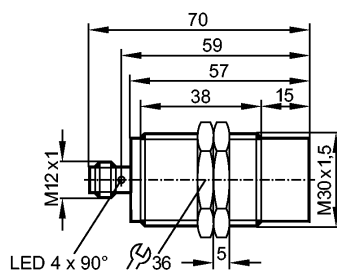

IIS215

IIK3015-BPKG/M/US104-DPS

Inductive sensors

Product characteristics

Inductive sensor

Metal thread M30 x 1.5

Quick disconnect

gold-plated contacts

Sensing range 15 mm; [nf] non-flush mountable

Electrical data

Electrical design	DC PNP
Operating voltage [V]	10...36 DC
Current consumption [mA]	< 10
Protection class	II
Reverse polarity protection	yes

Outputs

Output function	normally open
Voltage drop [V]	< 2.5
Current rating [mA]	100
Short-circuit protection	yes (non-latching)
Overload protection	yes
Switching frequency [Hz]	100

Monitoring range

Sensing range [mm]	15
Real sensing range (Sr) [mm]	15 ± 10 %
Operating distance [mm]	0...12.1

Accuracy / deviations

Correction factors	mild steel = 1 / stainless steel approx. 0.7 / brass approx. 0.5 / aluminium approx. 0.5 / Cu approx. 0.4	
Hysteresis [% of Sr]	1...20	
Switch-point drift [% of Sr]	-10...10	

Environment

Ambient temperature [°C]	-25...70
Protection	IP 67

Tests / approvals

EMC	EN 61000-4-2 ESD:	4 kV CD / 8 kV AD
	EN 61000-4-3 HF radiated:	10 V/m
	EN 61000-4-4 Burst:	2 kV
	EN 61000-4-5 Surge:	0.5 kV
	EN 61000-4-6 HF conducted:	10 V
	EN 55011:	class B

IIS215

IIK3015-BPKG/M/US104-DPS

Inductive sensors

MTTF	[Years]	1709
------	---------	------

Mechanical data

Mounting	non-flush mountable	
Housing materials	stainless steel (316L); active face: PBT orange	
Weight	[kg]	0.126

Displays / operating elements

Output status indication	LED	yellow (4 x 90°)
--------------------------	-----	------------------

Electrical connection

Connection	M12 connector; gold-plated contacts	
------------	-------------------------------------	--

Wiring

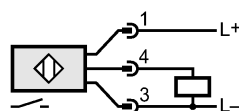

Accessories

Accessories (included)	2 lock nuts	
------------------------	-------------	--

Remarks

Pack quantity	[piece]	1
---------------	---------	---