

**IGT213**

IGKC012-ASKG/M/V4A/10M/WH

Inductive sensors

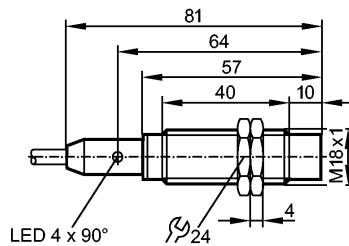

**Product characteristics**

Inductive sensor
Metal thread M18 x 1
Cable
Operation as 3-wire or 2-wire possible
Increased sensing range
Optical setting aid (2 LED)
Sensing range 12 mm; [nf] non-flush mountable

**Electrical data**

Electrical design	3-wire DC PNP; 2-wire DC PNP/NPN
Operating voltage [V]	10...30 DC
Current consumption [mA]	< 10
Protection class	II
Reverse polarity protection	yes

**Outputs**

Output function	normally open
Voltage drop [V]	< 2.8
Minimum load current [mA]	2; only in 2-wire operation
Leakage current [mA]	< 0.5; only in 2-wire operation
Current rating [mA]	100
Short-circuit protection	yes (non-latching)
Overload protection	yes
Switching frequency [Hz]	300

**Monitoring range**

Sensing range [mm]	12
Real sensing range (Sr) [mm]	12 ± 10 %
Operating distance [mm]	0...9.7

**Accuracy / deviations**

Correction factors	mild steel = 1 / stainless steel approx. 0.7 / brass approx. 0.5 / aluminium approx. 0.4 / copper approx. 0.3
Hysteresis [% of Sr]	1...20
Switch-point drift [% of Sr]	-10...10

**Environment**

Ambient temperature [°C]	0...100
Protection	IP 68 / IP 69K; "COP"

**Tests / approvals**

EMC	EN 61000-4-2 ESD:	4 kV CD / 8 kV AD
-----	-------------------	-------------------

**IGT213**

IGKC012-ASKG/M/V4A/10M/WH

**Inductive sensors**

	EN 61000-4-3 HF radiated:	10 V/m
	EN 61000-4-4 Burst:	2 kV
	EN 61000-4-5 Surge:	0.5 kV (line to line, Ri: 20hm)
	EN 61000-4-6 HF conducted:	10 V
	EN 55011:	class B
MTTF	[Years]	1359

**Mechanical data**

Mounting	non-flush mountable	
Housing materials	stainless steel (316L); active face: PEEK (polyether ether ketone)	
Weight	[kg]	0.388

**Displays / operating elements**

Output status indication	LED	yellow (4 x 90°)
Setting aid	LED	red

**Electrical connection**

Connection	PVC cable / 10 m; 3 x 0.34 mm <sup>2</sup> ; Ø 4.9 mm
------------	---

**Wiring**

Core colors

- BK black
- BN brown
- BU blue



**Accessories**

Accessories (included)	2 lock nuts
------------------------	-------------

**Remarks**

Remarks	suitable for PLC type 1 according to IEC 61131-2
Pack quantity	[piece] 1