

IFC234

IFK2004BFRKG/M/2LED/US-104-IRF

Inductive sensors

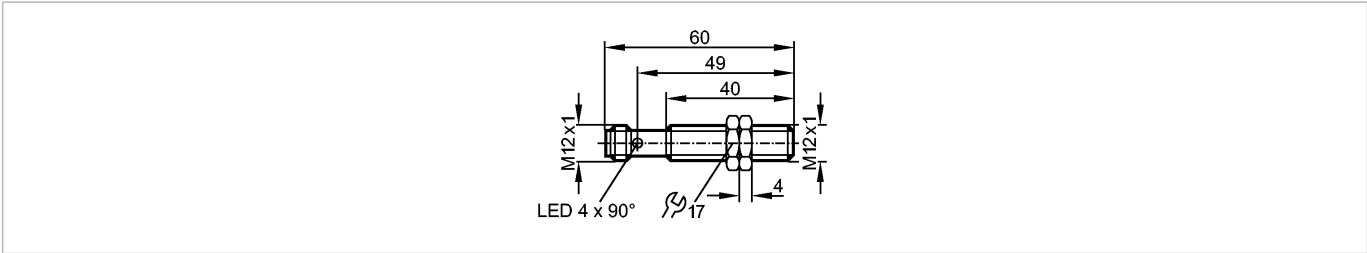

Product characteristics

Inductive sensor
Metal thread M12 x 1
Quick disconnect
Increased sensing range
Optical setting aid (2 LED)
gold-plated contacts
Sensing range 4 mm; [f] flush mountable

Electrical data

Electrical design	DC PNP/NPN
Operating voltage [V]	10...36 DC
Protection class	II
Reverse polarity protection	yes

Outputs

Output function	normally open / closed programmable
Voltage drop [V]	< 4.6
Minimum load current [mA]	4
Leakage current [mA]	< 1
Current rating [mA]	100
Short-circuit protection	yes (non-latching)
Overload protection	yes
Switching frequency [Hz]	700

Monitoring range

Sensing range [mm]	4
Operating distance [mm]	0...3.25

Accuracy / deviations

Correction factors	mild steel = 1 / stainless steel approx. 0.7 / brass approx. 0.5 / aluminium approx. 0.5 / Cu approx. 0.4
Hysteresis [% of Sr]	1...20

Environment

Ambient temperature [°C]	-25...70
Protection	IP 68; "Coolant"

Tests / approvals

EMC	EN 61000-4-2 ESD: 4 kV CD / 8 kV AD EN 61000-4-3 HF radiated: 10 V/m EN 61000-4-4 Burst: 2 kV EN 61000-4-6 HF conducted: 10 V EN 55011: class B
MTTF [Years]	1320

IFC234

IFK2004BFRKG/M/2LED/US-104-IRF

Inductive sensors

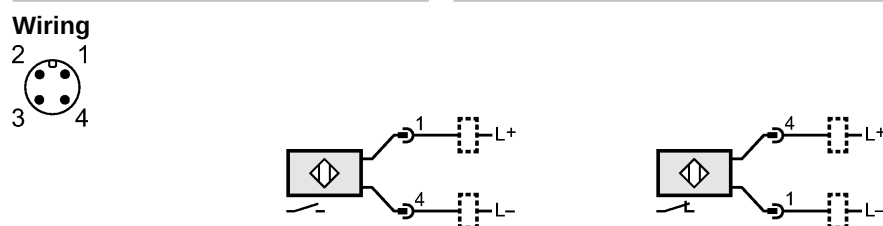
Mechanical data	
Mounting	flush mountable
Housing materials	housing: brass white bronze coated; active face: LCP uncolored
Weight [kg]	0.029
Displays / operating elements	
Output status indication LED	yellow (4 x 90°)
Setting aid LED	red (4 x 90°)
Electrical connection	
Connection	M12 connector; gold-plated contacts
Wiring 	
Accessories	
Accessories (included)	2 lock nuts
Remarks	
Pack quantity [piece]	1