

IF5653

IFA4002-CPKG/US-104-DPA

Inductive sensors

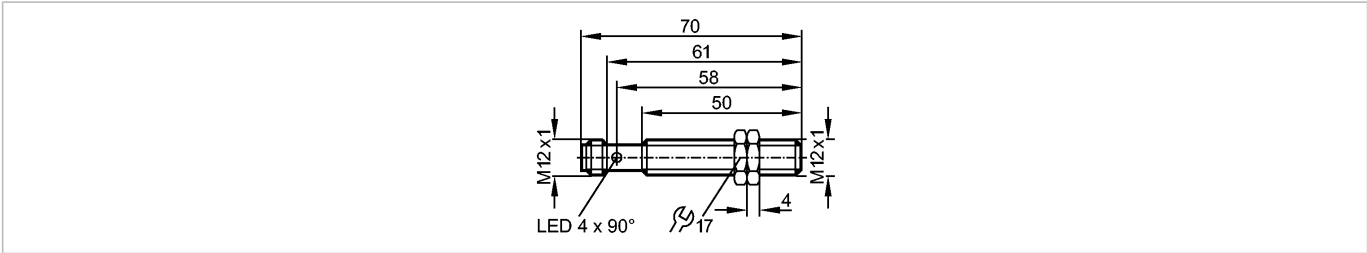

Product characteristics

Inductive sensor	
Metal thread M12 x 1	
Quick disconnect	
Sensing range 2 mm; [f] flush mountable	

Electrical data

Electrical design		DC PNP
Operating voltage [V]		10...36 DC
Current consumption [mA]		15 (24 V)
Protection class		II
Reverse polarity protection		yes

Outputs

Output function		complementary
Voltage drop [V]		< 3.5

Current rating

- Current rating (continuous) [mA]		250; 400 (...50 °C)
- Current rating (peak) [mA]		400
Short-circuit protection		yes (non-latching)
Overload protection		yes
Switching frequency [Hz]		1200

Monitoring range

Sensing range [mm]		2
Real sensing range (Sr) [mm]		2 ± 10 %
Operating distance [mm]		0...1.6

Accuracy / deviations

Correction factors		mild steel = 1 / stainless steel approx. 0.7 / brass approx. 0.5 / aluminium approx. 0.4 / copper approx. 0.3
Hysteresis [% of Sr]		1...15
Switch-point drift [% of Sr]		-10...10

Environment

Ambient temperature [°C]		-25...80
Protection		IP 65

Tests / approvals

EMC		EN 60947-5-2 EN 55011: class B
MTTF [Years]		1865

Mechanical data

Mounting		flush mountable
----------	--	-----------------

IF5653

IFA4002-CPKG/US-104-DPA

Inductive sensors

Housing materials	brass white bronze coated; active face: PC (polycarbonate)
-------------------	--

Weight	[kg] 0.03
--------	-----------

Displays / operating elements

Output status indication	LED	yellow (4 x 90°)
--------------------------	-----	------------------

Electrical connection

Connection	M12 connector
------------	---------------

Wiring

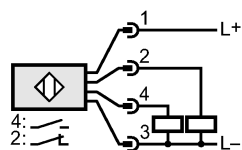

Accessories

Accessories (included)	2 lock nuts
------------------------	-------------

Remarks

Pack quantity	[piece] 1
---------------	-----------