

IA5135

IAE2010-FRKG/US-100-IRF

Inductive sensors

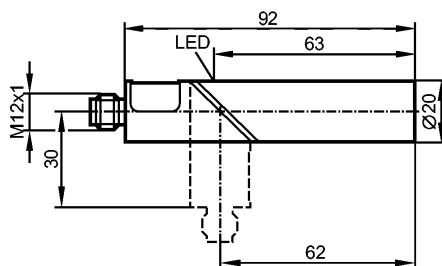

Product characteristics

Inductive sensor

Plastic housing Ø 20 mm

Quick disconnect

Sensing range 10 mm; [nf] non-flush mountable

Electrical data

Electrical design	DC PNP/NPN
Operating voltage [V]	10...55 DC
Protection class	II
Reverse polarity protection	yes

Outputs

Output function	normally open / closed programmable
Voltage drop [V]	< 4.6
Minimum load current [mA]	5
Leakage current [mA]	< 1
Current rating [mA]	400
Short-circuit protection	yes (non-latching)
Overload protection	yes
Switching frequency [Hz]	450

Monitoring range

Sensing range [mm]	10
Real sensing range (Sr) [mm]	10 ± 10 %
Operating distance [mm]	0...8.1

Accuracy / deviations

Correction factors	mild steel = 1 / stainless steel approx. 0.7 / brass approx. 0.4 / aluminium approx. 0.3 / copper approx. 0.2
Hysteresis [% of Sr]	1...15
Switch-point drift [% of Sr]	-10...10

Environment

Ambient temperature [°C]	-25...80
Protection	IP 65

Tests / approvals

EMC	EN 60947-5-2 EN 55011: class B
MTTF [Years]	1759

Mechanical data

Mounting	non-flush mountable
----------	---------------------



IA5135

IAE2010-FRKG/US-100-IRF

Housing materials	PBT; LED window: PC
Weight [kg]	0.092

Displays / operating elements

Output status indication	LED	yellow
--------------------------	-----	--------

Electrical connection

Connection	M12 connector
------------	---------------

Wiring

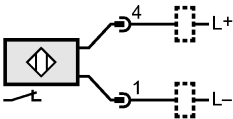
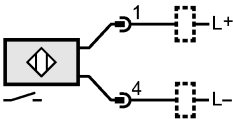

Accessories

Accessories (included)	Mounting clamp
------------------------	----------------

Remarks

Pack quantity	[piece]	1
---------------	---------	---