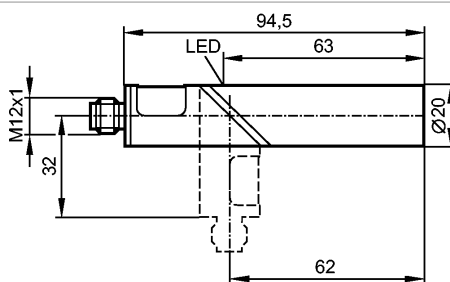

IA5106

IAE3010-BPKG/US-100-DPS

Inductive sensors

Product characteristics

Inductive sensor
 Plastic housing \varnothing 20 mm
 Quick disconnect
 Sensing range 10 mm; [nf] non-flush mountable

Electrical data

Electrical design	DC PNP
Operating voltage [V]	10...36 DC
Current consumption [mA]	15 (24 V)
Protection class	III
Reverse polarity protection	yes

Outputs

Output function	normally open
Voltage drop [V]	< 2.5
Current rating [mA]	250
Short-circuit protection	yes (non-latching)
Overload protection	yes
Switching frequency [Hz]	300

Monitoring range

Sensing range [mm]	10
Real sensing range (Sr) [mm]	$10 \pm 10\%$
Operating distance [mm]	0...8.1

Accuracy / deviations

Correction factors	mild steel = 1 / stainless steel approx. 0.7 / brass approx. 0.5 / aluminium approx. 0.4 / copper approx. 0.3
Hysteresis [% of Sr]	3...15
Switch-point drift [% of Sr]	-10...10

Environment

Ambient temperature [°C]	-25...80
Protection	IP 65

Tests / approvals

EMC	EN 60947-5-2 EN 55011:	class B
MTTF [Years]		1147

Mechanical data

Mounting	non-flush mountable
Housing materials	PBT; LED window: PC

IA5106

IAE3010-BPKG/US-100-DPS

Inductive sensors

Weight	[kg]	0.083
--------	------	-------

Displays / operating elements

Output status indication	LED	yellow
--------------------------	-----	--------

Electrical connection

Connection	M12 connector
------------	---------------

Wiring

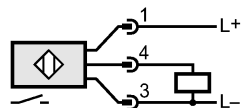

Accessories

Accessories (included)	Mounting clamp
------------------------	----------------

Remarks

Pack quantity	[piece]	1
---------------	---------	---