

EVT395

ADOAH050VAS0010G05

Connection technology

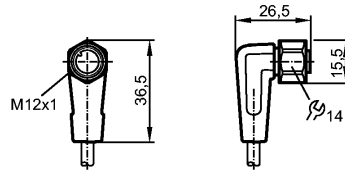

Product characteristics

Socket

For sensors with

M12 connector

Free from silicone

gold-plated contacts

For hygienic and wet areas in the food industry

Electrical data

Electrical design		AC/DC
Operating voltage	[V]	30 AC / 36 DC
Current rating	[A]	4; cULus: 3 A
Protection class		III

Environment

Ambient temperature	[°C]	-25...100, cULus: max. 50 °C
Ambient temperature (moving)	[°C]	5...100, cULus: max. 50 °C
Protection		IP 65 / IP 67 / IP 68 / IP 69K

Mechanical data

Design		angled
Material body		housing: PVC orange; sealing: EPDM
Material nut		stainless steel 316L / 1.4404
Tightening torque for knurled nut	[Nm]	0.6...1.5
Drag chain suitability		<p>Bending radius for flexible applications:</p> <p>min. 10 x cable diameter max. 3.3 m/s for a horizontal travel length of 5 m and max. acceleration of 5 m/s²</p> <p>Travel speed:</p> <p>Bending cycles:</p> <p>Torsional strain:</p> <p>> 1 million ± 180 °/m</p>
Weight	[kg]	0.471

Electrical connection

Connection		PVC cable / 10 m; 5 x 0.25 mm ² (32 x Ø 0.1 mm); Ø 5.2 mm; screened, screen not connected to the socket
Sheath color		orange

Wiring



EVT395

ADOAH050VAS0010G05

Connection technology

Core colors

BK black
BN brown
BU blue
GY grey
WH white

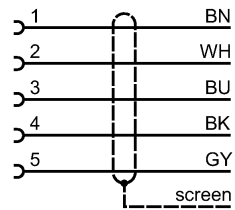
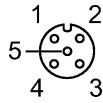

Remarks

Pack quantity [piece] 1