

EVT393

ADOAH050VAS0002G05

Connection technology

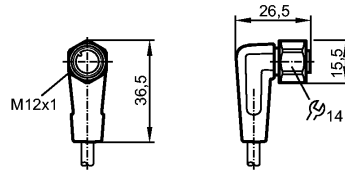

Product characteristics

Socket

For sensors with

M12 connector

Free from silicone

gold-plated contacts

For hygienic and wet areas in the food industry

Electrical data

| | | |
|-------------------|-----|---------------|
| Electrical design | | AC/DC |
| Operating voltage | [V] | 30 AC / 36 DC |
| Current rating | [A] | 4; cULus: 3 A |
| Protection class | | III |

Environment

| | | |
|------------------------------|------|--------------------------------|
| Ambient temperature | [°C] | -25...100, cULus: max. 50 °C |
| Ambient temperature (moving) | [°C] | 5...100, cULus: max. 50 °C |
| Protection | | IP 65 / IP 67 / IP 68 / IP 69K |

Mechanical data

| | | |
|--|------|---|
| Design | | angled |
| Material body | | housing: PVC orange; sealing: EPDM |
| Material nut | | stainless steel 316L / 1.4404 |
| Tightening torque for knurled nut [Nm] | | 0.6...1.5 |
| Drag chain suitability | | <p>Bending radius for flexible applications:</p> <p>min. 10 x cable diameter max. 3.3 m/s for a horizontal travel length of 5 m and max. acceleration of 5 m/s²</p> <p>Travel speed:</p> <p>Bending cycles:</p> <p>Torsional strain:</p> <p>> 1 million ± 180 °/m</p> |
| Weight | [kg] | 0.112 |

Electrical connection

| | | |
|--------------|--|--|
| Connection | | PVC cable / 2 m; 5 x 0.25 mm ² (32 x Ø 0.1 mm); Ø 5.2 mm; screened, screen not connected to the socket |
| Sheath color | | orange |

Wiring



EVT393

ADOAH050VAS0002G05

Connection technology

Core colors
BK black
BN brown
BU blue
GY grey
WH white

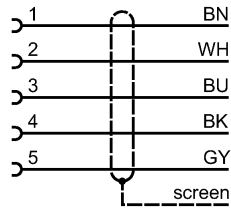
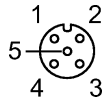

Remarks

Pack quantity [piece] 1