

no longer available - archive entry

Discontinued article

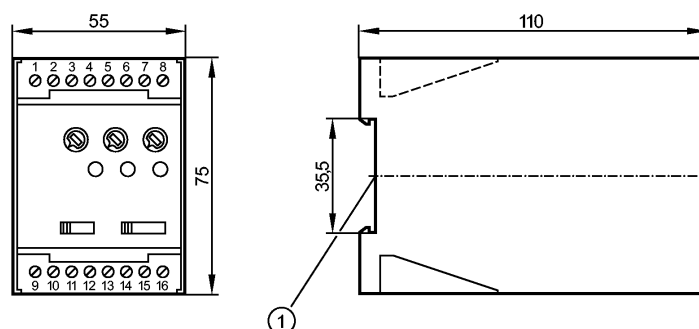

1: Mounting on DIN rail



### Product characteristics

Speed monitor

D100

Housing for DIN rail mounting

### Application

Application	evaluation of pulse sequences with regard to overspeed and underspeed; rotational speed monitoring
Switching function	F1-F4, with 4-step slide switch
Switching output	relay (1 changeover contact)

### Electrical data

Nominal voltage	[V]	12 / 24 DC
Voltage tolerance	[%]	± 10
Sensor supply	[V]	24 DC (max. 30mA)

### Inputs

Input frequency (max.) [pulses/min]	15000 (250 Hz)
-------------------------------------	----------------

### Outputs

Relay	
Contact rating	8 A / 1250 VA / 250 V AC

### Measuring / setting range

Setting range	[pulses/min.]	5...5000
Adjustment of the switch point		3 ranges preselectable, fine adjustment with potentiometer
Hysteresis	[% of Sp]	5...100
Start-up delay	[s]	0.5...15

### Accuracy / deviations

Repeatability	[% / Sp]	1
---------------	----------	---

### Environment

Ambient temperature	[°C]	-20...70
Protection housing / terminals		IP 40 / IP 20

### Safety classification

MTTF	[a]	400
------	-----	-----

### Mechanical data

Housing materials		plastics
-------------------	--	----------

# DD0008

D100/ 12VDC

Evaluation systems, power supplies

Weight	[kg]	0.272
--------	------	-------

## Displays / operating elements

Power	LED	green
Input pulses	LED	yellow
Output status indication	LED	green (lights when the output relay is energised)

## Electrical connection

Connection	16 terminals...2.5 mm <sup>2</sup>
------------	------------------------------------

### Wiring

- 01: n.c.
- 02: n.c.
- 03: DC Sensor supply (-)
- 04: sensor signal pnp
- 05: DC Sensor supply (+)
- 06: 24 V DC Supply voltage (-)
- 07: 24 V DC Supply voltage (+)
- 08: n.c.
- 09: n.c.
- 10: n.c.
- 11: n.c.
- 12: Relay (normally closed)
- 13: Relay (common)
- 14: Relay (normally open)
- 15: 12 V DC Supply voltage (+)
- 16: 12 V DC Supply voltage (-)

n.c. = not connected

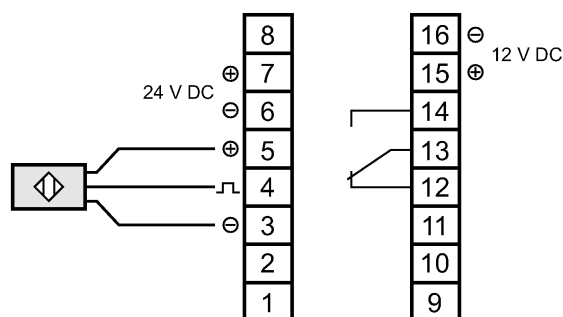

## Remarks

Pack quantity	[piece]	1
---------------	---------	---

ifm efector, inc. • 1100 Atwater Drive • Malvern • PA 19355 — We reserve the right to make technical alterations without prior notice. — US — DD0008 — 10.12.2014

**no longer available - archive entry**

**Discontinued article**