

AC1254

PSU-1AC/ASi-4A

AS-Interface bus system

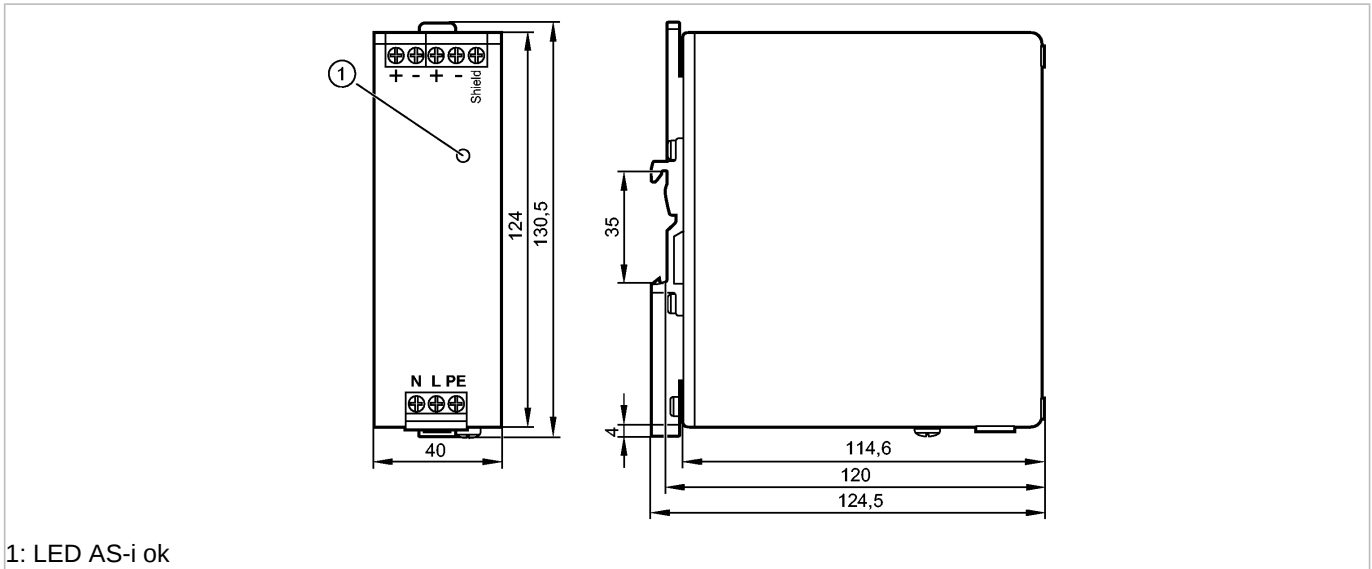

1: LED AS-i ok



Product characteristics

Power supply

AS-i power supply 115/230 V AC

Integrated data decoupling

Application

Application

AS-i system voltage for masters, sensors, actuators and modules

Electrical data

Input voltage range	[V]	100...120 AC / 200...240 AC; ± 10 %; automatic range selection
Nominal voltage	[V]	115 / 230 AC
Frequency range	[Hz]	47...64
Nominal frequency	[Hz]	50 / 60
Output voltage (AS-i)	[V]	30.5 DC
Output power	[W]	122
Output power peak	[W]	134; briefly to load bus capacities after power on
Power factor		0.56 (120 V AC; 60 Hz) / 0.47 (230 V AC; 50 Hz)
Power reserve	[%]	10
Output current (AS-i)	[A]	4
Residual ripple	[mVpp]	< 50
Switch-on peak current	[A]	3 (120 V AC; 60 Hz) / 3 (230 V AC; 50 Hz)
Inrush current limitation		yes
Efficiency	[%]	88 (120 V AC; 60 Hz) / 89.3 (230 V AC; 50 Hz)
Short-circuit proof		yes
Overload protection		yes
Overload performance		constant output current
Oversvoltage protection	[V]	< 36
Excess temperature protection		yes
External input protection		≤ B-10 A / ≤ C-6 A
Power-on delay time	[ms]	≤ 900
Derating	[W/K]	3 (60...70 °C)
Mains buffering time	[ms]	70 (120 V AC; 60 Hz) / 70 (230 V AC; 50 Hz)

AC1254

PSU-1AC/ASi-4A

AS-Interface bus system

Protection class	
Input current	[A]
Power loss	[W]
Back feeding protection	[V]

	I
	2.05 (120 V AC; 60 Hz) / 1.23 (230 V AC; 50 Hz)
	16.6 (120 V AC; 60 Hz) / 14.6 (230 V AC; 50 Hz)
	≤ 35 DC

Block diagram

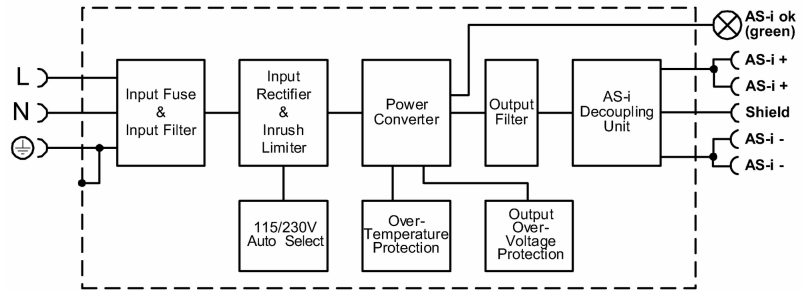

Output curve

Output Voltage

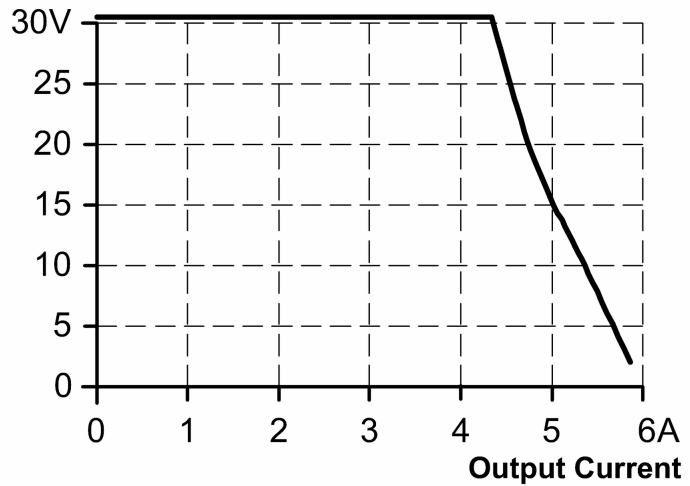

Characteristic curve for degree of efficiency / power loss

Efficiency

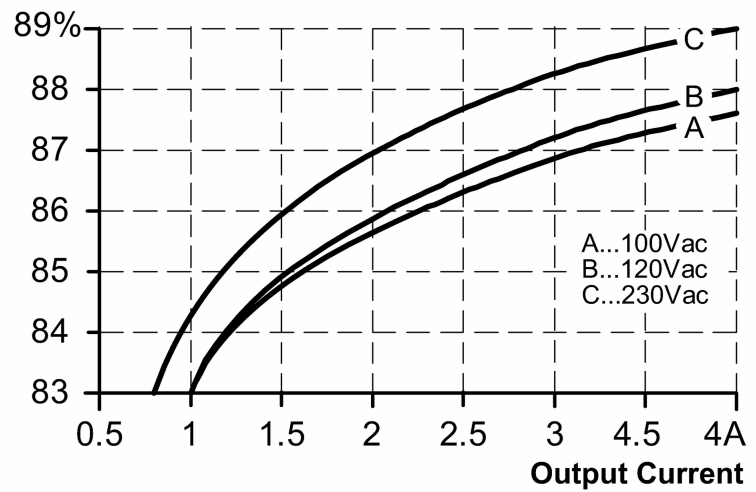

AC1254

PSU-1AC/ASi-4A

AS-Interface bus system

Characteristic curve for derating

Allowed Output Current

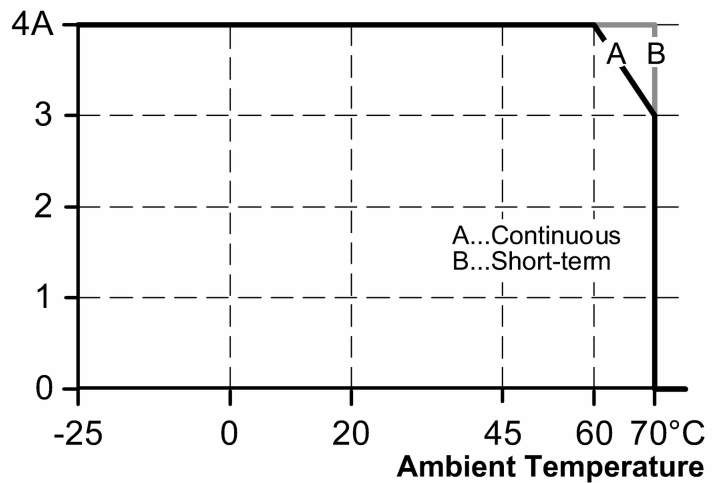

Characteristic curve for mains buffering time

Hold-up Time

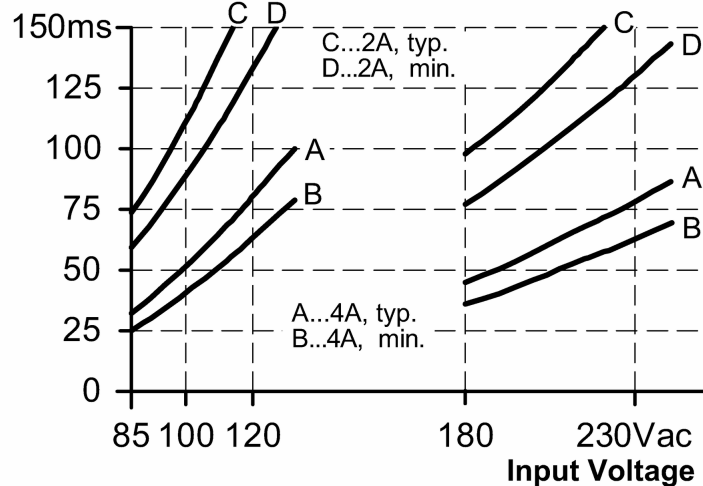

Outputs

Parallel connection of outputs

no

Series connection of outputs

no

Environment

Ambient temperature

[°C]

-25...70, observe the free space for convection (see operating instructions)

Storage temperature

[°C]

-40...85

Max. relative air humidity

[%]

95, (IEC 60068-2-30)

Protection

IP 20

Degree of soiling

2; (IEC 62103) conductive soiling not permitted

Tests / approvals

EMC

EN 61000-6-1
EN 61000-6-2
EN 61000-6-4

UL

UL 508 (Industrial Control Equipment)

Shock resistance

IEC 60068-2-27

30 g (6 ms) / 20 g (11 ms)

Vibration resistance

IEC 60068-2-6

± 1.6 mm (2...25 Hz) / 2 g
(17.8...500 Hz)

MTBF [h]

789000

AS-i classification



AC1254

PSU-1AC/ASi-4A

AS-Interface bus system

AS-i certificate	98601
------------------	-------

Mechanical data

Housing materials	steel sheet
Installation	rail TH35 (to EN 60715)
Weight [kg]	0.615

Displays / operating elements

Function display	LED	green (indication AS-i voltage)
------------------	-----	---------------------------------

Electrical connection

Connection	screw terminals
------------	-----------------

Wiring

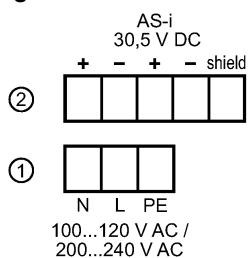

- 1: primary
- 2: secondary

Remarks

Pack quantity	[piece]	1
---------------	---------	---